

FINA

PERMIT  
CITY OF NAPOLEON, OHIO - BUILDING DEPARTMENT  
West Riverview Avenue, Napoleon, Ohio 43545 - (419) 592-4010

Permit No. 3381 Issued 10/19/94

Job Location 582 Becklee

Lot 6 Van Hyning Estates

Issued by Brent N. Damman

Owner Robert Beck 592-8307

Address 11-622 Co. Rd. M Napoleon

Agent Beck's Construction 592-8307

Address 11-622 Co. RD. M Napoleon

Use Type - Residential X

Other - Describe \_\_\_\_\_

No. Dwelling Units \_\_\_\_\_

New X Replacement \_\_\_\_\_

Add'n. \_\_\_\_\_ Alter \_\_\_\_\_ Remodel \_\_\_\_\_

Mixed Occupancy \_\_\_\_\_

Change of Occupancy \_\_\_\_\_

Estimated Cost \$ 75,000.00

FEES	BASE	PLUS	TOTAL
<input checked="" type="checkbox"/> Building	\$ 9.00	\$ 178.00	\$ 187.00
<input checked="" type="checkbox"/> Electrical	\$ 15.000	\$ 75.00	\$ 90.00
<input checked="" type="checkbox"/> Plumbing	\$ 9.00	\$ 45.00	\$ 54.00
<input checked="" type="checkbox"/> Mechanical	\$ 18.00	\$ 14.00	\$ 32.00
<input type="checkbox"/> Demolition	\$	\$	\$
<input type="checkbox"/> Zoning	\$	\$	\$
<input type="checkbox"/> Sign	\$	\$	\$
<input checked="" type="checkbox"/> Water Tap	\$ 650.00	\$	\$ 650.00
<input type="checkbox"/> Sew. Insp.	\$	\$	\$
<input checked="" type="checkbox"/> Sewer Tap	\$ 60.00	\$	\$ 60.00
<input checked="" type="checkbox"/> Temp. Water	\$ 5.00	\$	\$ 5.00
<input checked="" type="checkbox"/> Temp. Elec.	\$ 10.00	\$	\$ 10.00
TOTAL FEES.....			\$ 1088.00
LESS FEES PAID.....			\$
BALANCE DUE.....			\$

ZONING INFORMATION

district	lot dimensions		area	front yd	side yd	rear yd
max hgt	no pkg spaces	no ldg spaces	max cover	petition or appeal req'd		date appr

WORK INFORMATION

Size: Length 61' Width 49' Stories 1 Ground Floor Area 1722

Height 16' Building Volume (for Demo. Permit) \_\_\_\_\_

Electrical: \_\_\_\_\_

Plumbing: \_\_\_\_\_

Mechanical: \_\_\_\_\_

Additional Information: New Home

Date 11-8-94 Applicant Signature Robert D. Beck

# INSPECTION RECORD

	UNDERGROUND			ROUGH-IN						.. 14		
	Type	Date	By	Type	Date	By	Type	Date	By	Type	Date	By
<b>PLUMBING</b>	Building Drains			Drainage, Waste & Vent Piping	12/21	BD	Indirect Waste	12/21	BD	Drainage, Waste & Vent Piping	2/15	BD
	Water Piping									Backflow Prevention		
	Building Sewer			Water Piping	12/21	BD	Condensate Lines			Water Heater	2/15	BD
	Sewer Connection	1/5	BD								FINAL APPROVAL	2/15
<b>MECHANICAL</b>	Refrigerant Piping			Refrigerant Piping			Chimney(s)			Grease Exhaust System		
				Duct Furnace(s)			Fire Dampers			Air Cond. Unit(s)		
	Ducts/ Plenums			Ducts/ Plenums	12/22	BD	<input type="checkbox"/> Radiant Htr(s) <input type="checkbox"/> Unit Htr(s)			Refrigeration Equipment		
				Duct Insulation			Pool Heater			Furnace(s)	2/15	BD
				Combustion Products Vents			Ventilation <input type="checkbox"/> Supply <input type="checkbox"/> Exhst.	2/15	BD	FINAL APPROVAL	2/15	BD
<b>ELECTRICAL</b>	Conduits & or Cable			Conduits/ Cable			<input type="checkbox"/> Range <input type="checkbox"/> Dryer			Temp Service Temp Lighting	2/4	
	Grounding & or Bonding			Rough Wiring	12/22	BD	<input type="checkbox"/> Generator(s) <input type="checkbox"/> Motors			Fixtures Lampholders	2/15	BD
	Floor Ducts Raceways			Service Panel Switchboard	2/15	BD	<input type="checkbox"/> Water Htr <input type="checkbox"/> Welder			Signs		
	Service Conduit			Busways Ducts			<input type="checkbox"/> Heaters <input type="checkbox"/> Heat Cable			Electric Mtr. Clearance	2/15	BD
	Temporary Power Pole			Subpanels			<input type="checkbox"/> Duct Htr(s) <input type="checkbox"/> Furnace(s)			FINAL APPROVAL		
<b>BUILDING</b>	Location, Set-backs, Esmt(s)			Exterior Wall Construction	12/21	BD	Roof Covering Roof Drainage	12/21	BD	Smoke Detector	2/15	BD
	Excavation	10/19	BD				Exterior Lath			Demolition (sewer cap)		
	Footings & Reinforcing	10/19	BD				<input checked="" type="checkbox"/> Interior Lath <input type="checkbox"/> Wallboard	2/15	BD			
	Floor Slab			Interior Wall Construction	12/21	BD	Fire Wall(s)			Building or Structure	2/15	BD
	Foundation Walls	10/19	BD	Columns & Supports			Fireplace Chimney	2/15	BD			
	Sub-soil Drain			Crawl Space <input type="checkbox"/> Vent <input type="checkbox"/> Access			Attic <input type="checkbox"/> Vent <input type="checkbox"/> Access	2/15	BD			
	Piles			Floor System(s)	12/21	BD				FINAL APPROVAL BLDG. DEPT.	2/15	BD
			Roof System	12/21	BD	Special Insp Reports Rec'd			Certificate of Occupancy Issued	2/16	BD	
<b>ADDITIONAL</b>	<b>INSPECTIONS, CORRECTIONS, ETC.</b>						<b>INSPECTIONS, CORRECTIONS, ETC.</b>					

*Permit stamp only set  
complete at signature*

**APPLICATION FOR**  
 Residential, Building, Electrical, Plumbing, Mechanical, and Demolition Permit  
 FROM - The City of Napoleon, Ohio, Building Department  
 255 West Riverview Avenue; P.O. Box 151; Napoleon, Ohio 43545 - Telephone (419) 592-4010

142

ENTRY NO. \_\_\_\_\_  
 PERMIT NO. 3381 ISSUED 10-19-94  
 JOB LOCATION 582 Becklee  
 LOT 6 VanHyning Estates  
 (Subdivision or Legal Description)  
 ISSUED BY BND  
 (Building Official)  
 OWNER Robert Beck PHONE 592-8307  
 ADDRESS 11-622 Co. Rd. M Napoleon  
 AGENT Becks Construction PHONE 592-8307  
 ADDRESS 11-622 Co. Rd. m Napoleon  
 USE: (X) Residential ( ) Commercial ( ) Industrial  
 ( ) Other \_\_\_\_\_  
 WORK: (X) New ( ) Addition ( ) Replacement ( ) Remodel  
 ESTIMATED COST = \$ 75,000

	Base	Plus	Total
(X) Building	\$ <u>9.00</u>	\$ <u>178.00</u> <small>26.00 142.00</small>	\$ <u>187.00</u>
(X) Electrical	\$ <u>15.00</u>	\$ <u>75.00</u>	\$ <u>90.00</u>
(X) Plumbing	\$ <u>9.00</u>	\$ <u>45.00</u>	\$ <u>54.00</u>
(X) Mechanical	\$ <u>18.00</u>	\$ <u>14.00</u>	\$ <u>32.00</u>
( ) Demolition	\$ _____	\$ _____	\$ _____
( ) Zoning	\$ _____	\$ _____	\$ _____
( ) Sign	\$ _____	\$ _____	\$ _____
(X) Water Tap	\$ <u>650.00</u>	\$ _____	\$ <u>650.00</u>
(X) Sewer Tap	\$ <u>60.00</u>	\$ _____	\$ <u>60.00</u>
(X) Temp Water	\$ <u>5.00</u>	\$ _____	\$ <u>5.00</u>
(X) Temp Elec.	\$ <u>10.00</u>	\$ _____	\$ <u>10.00</u>

Additional Plan Review: Structure \_\_\_\_\_ Hours \_\_\_\_\_  
 Electric \_\_\_\_\_ Hours \_\_\_\_\_

TOTAL FEES . . . . . \$ 1088.00  
 Less Fees Paid . . . . . \$ \_\_\_\_\_  
 BALANCE DUE . . . . . \$ 1088.00

**ZONING INFORMATION**

District	Lot Dimensions	Area	Front Yard	Side Yard	Rear Yard
----------	----------------	------	------------	-----------	-----------

Max Height	No. Pkg. Spaces	No. Ldg. Spaces	Max Cover	Petition or Appeal Required-Date
------------	-----------------	-----------------	-----------	----------------------------------

**WORK INFORMATION**

Building: Ground Floor Area 1722 sq. ft. Basement Floor Area 1353 sq. ft.  
 Garage Floor Area 526 sq. ft. 2nd Floor Area \_\_\_\_\_ sq. ft. Other Porch 97 sq. ft.  
 Size: Width 49' Length 61 Stories 1 Height 16'  
 Building Volume (for Demolition Permit) \_\_\_\_\_ cubic feet  
 Description of Work: New Home

**ELECTRICAL:** Contractor \_\_\_\_\_ Phone \_\_\_\_\_  
Address \_\_\_\_\_ ESTIMATED COST = \$ \_\_\_\_\_  
Type of Work:  New  Service Change  Rewiring  Add'l Wiring TEMPORARY ELEC. REQUIRED -  Yes  No  
Size of Service 200 Underground  Overhead \_\_\_\_\_ Number of New Circuits 25

Description of Work: \_\_\_\_\_

**PLUMBING:** Contractor \_\_\_\_\_ Phone \_\_\_\_\_  
Address \_\_\_\_\_ ESTIMATED COST = \$ \_\_\_\_\_

WATER TAP REQUIRED --  Yes  No Size \_\_\_\_\_ Type of Pipe \_\_\_\_\_ Water Dist. Pipe \_\_\_\_\_  
SANITARY SEWER TAP REQUIRED -  Yes  No Size \_\_\_\_\_ Type of Pipe \_\_\_\_\_ Dr. Waste Vt. Pipe \_\_\_\_\_  
STREET SEWER TAP REQUIRED -  Yes  No Type of Pipe \_\_\_\_\_ STREET TO BE OPENED -  Yes  No  
Main Building Drain Size = \_\_\_\_\_ Main Vent Pipe Size = \_\_\_\_\_

**LIST NUMBER OF PLUMBING FIXTURES BELOW:**  
Water Closets = 3 Bathtubs = 2 Showers = 1 Lavatories = 4 Kitchen Sinks = 1 Disposal = 1  
Clothes Washer = 1 Floor Drains = \_\_\_\_\_ Dishwasher = 1 Other L.T. - 1 Total = 15

Description of Work: \_\_\_\_\_

**MECHANICAL:** Contractor \_\_\_\_\_ Phone \_\_\_\_\_  
Address \_\_\_\_\_ ESTIMATED COST = \$ \_\_\_\_\_

HEATING SYSTEM -  Forced Air  Gravity  Hot Water  Steam  Unit Heaters  Radiant  Baseboard  
TYPE OF FUEL -  Electric  Natural Gas  Propane  Wood  Coal  Solar  Geothermal Other \_\_\_\_\_  
NUMBER OF HEAT ZONES = 1 HOT WATER -  One (1) Pipe  Two (2) Pipes  Series Loop  
ELECTRIC HEAT - Number of Circuits \_\_\_\_\_ Number of Furnaces 1 Number of Hot Air Runs 16  
Number of Hot Water Radiators \_\_\_\_\_ Total Heat Loss \_\_\_\_\_ Rated Capacity of Furnace/Boiler \_\_\_\_\_  
LOCATION OF HEATING UNITS -  Crawl Space  Floor Level  Attic  Suspended  Roof  Outside

Description of Work: \_\_\_\_\_

**DRAWINGS REQUIRED:** All applications must be accompanied by two (2) complete sets of Drawings including Site Plans, Foundation Plans, Floor Plans, Structural Framing Plans, Exterior Elevations, Section and Details, Stair Details, Electrical Layout, Plumbing Isometric, Heating Layout, etc. All Plans shall be drawn to scale, show all existing structure on the Site Plans, and show electric panel and furnace locations.

**READ AND SIGN BELOW:** The undersigned hereby makes application for a Permit for all work described herein and agrees to complete the work in strict accordance with all applicable provisions of the current edition of the C.A.B.O. Building Code, the Napoleon Building and Zoning Codes, the Napoleon Engineering Department Rules and Regulations, Standard Specifications and other pertinent sections of the Napoleon Code of Ordinances.

Signature of Applicant \_\_\_\_\_ Date \_\_\_\_\_

WATER TAPPING PERMIT

issued by

The Napoleon Water Distribution Department

255 West Riverview Ave. Napoleon, Ohio 43545 Pn. 592-4010

Permit No. W-0482 Issued 11-3-94 Received of Decks Construction (\$ 550 ) .00

(Charge for tapping permit to supply water service to) Lot No. 6 Sub Div. Van Hynning Estates

Street No. 582 Becklee Tap Size 1" Cost \$ .00 Plumber Meyers PCH

Date completed \_\_\_\_\_ Approved by \_\_\_\_\_ water distribution dept. \_\_\_\_\_ finance director

Name \_\_\_\_\_ Size of tap 1" Date 11-15-94 Street and No. 582 Becklee

Old Tap No. \_\_\_\_\_ New Tap No. 94164 Size and Kind of Main 8" C-900

Location of Main 5' South of South CURB Depth of Main 4'

Distance from Hydrant/Valve 116' West of Hyd #447 Distance to Curb Stop from Corp. 46'

Note: (Electric Telephone & Cable T.V. 4' South of CURB stop Depth 3'-4')

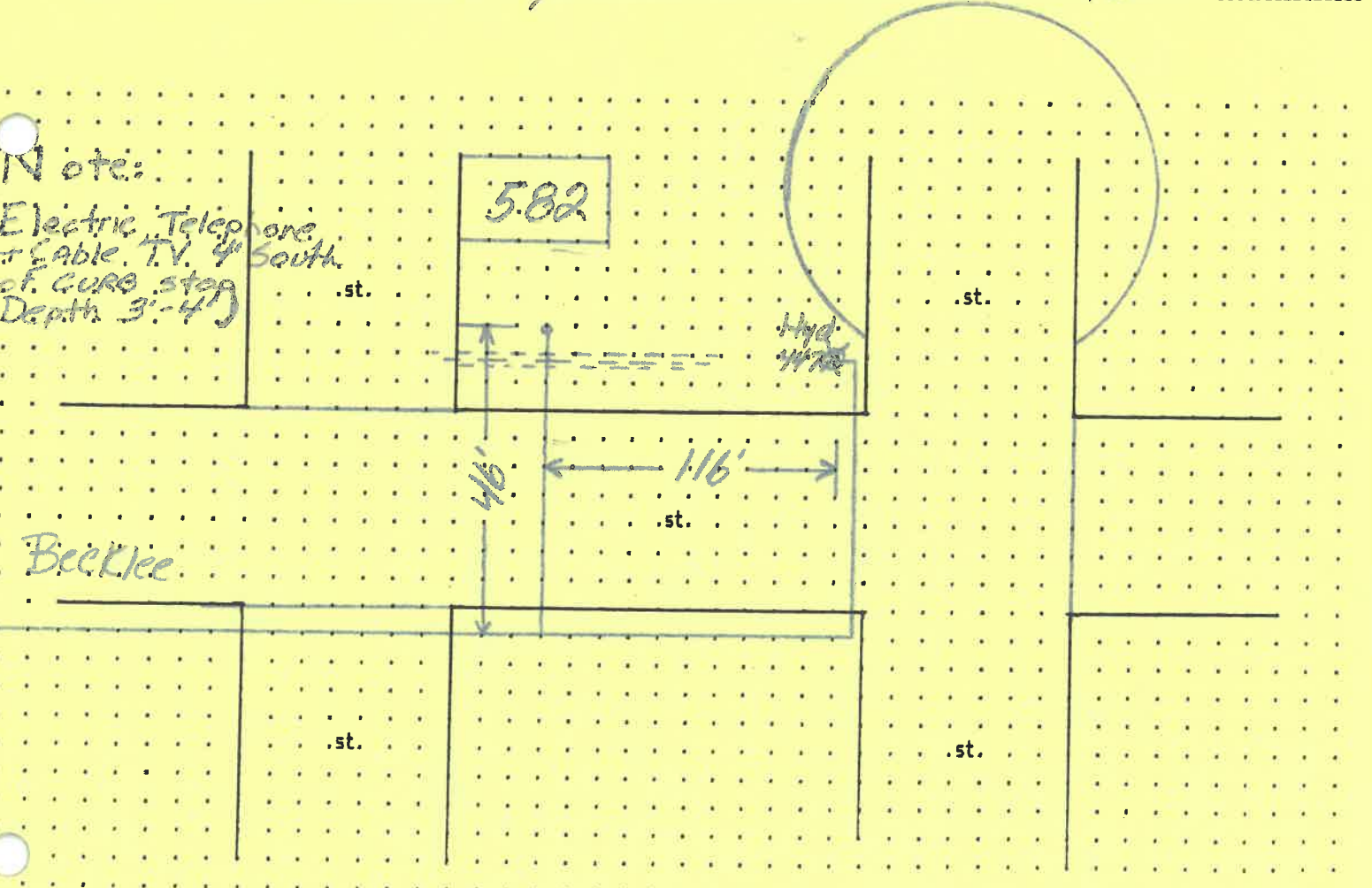

Becklee



\* \* \* S U B P O E N A \* \* \*  
Revised Code, Sec. 2932.19

Case No: CVI 960252 A

Date: Aug 26, 1996

Parsell, Rod

NAPOLEON MUNICIPAL COURT

P.O.Box 502

Napoleon, Ohio 43545

(419) 592-2851

vs

Beck's Construction

\* \* \* \* \*

The State of Ohio,  
Henry County

To any officer with the proper authority; Greeting:

You are hereby commanded to subpoena: BRENT DAMMAN  
C/O City Hall  
Napoleon, Oh 43545

to appear before the NAPOLEON MUNICIPAL COURT P.O.Box 502  
Napoleon, Ohio 43545 on 09-04-96 at 9.00AM to testify as a  
witness on behalf of Plaintiff \_\_\_\_\_ in the above Court  
Case and not depart the Court without leave.

Failure to comply with this order will subject you to the penalty of  
the law.

WITNESS my hand and the seal of said Court, this Aug 26, 1996

Ruth H. Labie  
Clerk of Court

By: Betty Marchugh  
Betty Marchugh  
Deputy Clerk

RETURN OF SERVICE OF SUBPOENA

	Fees
Service _____ \$ _____	
Miles(_____) \$ _____	
_____	
_____	
_____	
Total \$ _____	

Received this writ \_\_\_\_\_ 19 \_\_\_\_  
and afterwards, on \_\_\_\_\_ 19 \_\_\_\_

- ( ) I delivered a copy to above personally.
- ( ) I read this writ to above personally.
- ( ) I left a copy of writ at place of residence.
- ( ) I was unable to locate individual summoned.

Served by: \_\_\_\_\_

582  
Becklee







# City of NAPOLEON, OHIO

255 RIVERVIEW AVENUE, P.O. BOX 151  
NAPOLEON, OHIO 43545-0151  
(419) 592-4010

578 Beckle

August 25th, 1995

Mayor  
Robert G. Heft

Mr. Robert Beck  
Becks Construction  
11-622 Co. Rd. M  
Napoleon, Ohio 43545

Members of Council  
John E. Church, President  
Michael J. DeWit  
James Hershberger  
Sarah Peper  
Terri A. Williams  
Travis B. Sheaffer  
Dennis Fligor

Re. Lot # 8 VanHyning Estates  
watercourse obstruction.

Dear Mr. Beck

City Manager  
Marc S. Gerken

This letter is to inform you that I have determined that the ravine area which you have filled across lot # 8 of the VanHyning Estates Subdivision, is a natural water course of the VanHyning Creek. The obstruction you have created dictates the maintaining of a nuisance according to City Code Section 139.08 (attached). Therefore, I am requesting that you remove the fill from this natural water course and restore the area affected.

Finance Director  
Gregory J. Heath

Furthermore this fill area was not shown on the grading plan submitted with house site plan # VHLDT8, which invalidates any and all permits that have been issued.

Law Director  
David M. Grahn

In the event you do not comply with this request within 30 days of receipt of this notice, I shall place a stop work order upon the property in question. There are also criminal proceedings which can be used for remedy.

Sincerely

Brent N Damman  
Building & Zoning  
Administrator

cc. Marc S. Gerken, City Manager



semi-airtight container which has a capacity of 1-1/2 cubic feet or more and an opening of 50 square inches or more and which has a door or lid equipped with a hinge, latch or other fastening device capable of securing the door or lid, without rendering the equipment harmless to human life by removing the hinges, latches or other hardware which may cause a person to be confined therein. This section shall not apply to an icebox, refrigerator or other airtight or semi-airtight container located in that part of a building occupied by a dealer, warehouseman or repairman.

(B) Whoever violates this section is guilty of a misdemeanor of the fourth degree. (R.C. §§ 3767.29, 3767.99) ('65 Code, § 74.09) Penalty, see § 130.99

#### § 139.07 DISPOSAL OF GARBAGE AND OTHER WASTE.

(A) For the purpose of this section, **LITTER** shall mean garbage, trash, waste, rubbish, ashes, cans, bottles, wire, paper, cartons, boxes, automobile parts, furniture, glass, or anything else of an unsightly or unsanitary nature thrown, dropped, discarded, placed, or deposited by a person on public property, on private property not owned by him, or in or on waters of the state, unless the person has:

(1) Been directed to do so by a public official as part of a litter collection drive;

(2) Thrown, dropped, discarded, placed, or deposited the material in a receptacle in a manner that prevented its being carried away by the elements; or

(3) Been issued a permit or license covering the material pursuant to R.C. Chapters 3734 or 6111.

(B) No person shall regardless of intent, throw, drop, discard, place, or deposit litter or cause litter to be thrown, dropped, discarded, placed, or deposited on any public property, on private property not owned by him, or in or on waters of the state, unless the person has:

(1) Been directed to do so by a public official as a part of a litter collection drive;

(2) Thrown, deposited, discarded, placed, or deposited the litter in a litter receptacle in a manner that prevents its being carried away by the elements; or

(3) Been issued a permit or license covering the litter pursuant to R.C. Chapters 3734 or 6111.

(C) This section may be enforced by any sheriff, deputy sheriff, police officer of a municipal corporation, police constable or officer of a township or township police district, game protector, park officer, forest officer, preserve officer, conservancy district police officer, or any other law enforcement officer within his jurisdiction. (R.C. § 3767.32)

(D) Whoever violates this section is guilty of a misdemeanor of the third degree. The sentencing court may, in addition to or in lieu of the penalty provided in this division require a person who violates this section to remove litter from any public or private property, or in or on waters of the state. (R.C. § 3767.99(C)) Penalty, see § 130.99

#### § 139.08 MAINTAINING A NUISANCE.

(A) No person shall erect, continue, use, or maintain a building, structure, or place for the exercise of a trade, employment, or business, or for the keeping or feeding of an animal which, by occasioning noxious exhalations or noisome or offensive smells, becomes injurious to the health, comfort, or property of individuals or of the public. No person shall cause or allow offal, filth, or noisome substances to be collected or remain in any place to the damage or prejudice of others or of the public. No person shall unlawfully obstruct or impede the passage of a navigable river, harbor, or collection of water, or corrupt or render unwholesome or impure, a watercourse, stream, or water, or unlawfully divert the watercourse from its natural course or state to the injury or prejudice of others.

(B) Whoever violates this section is guilty of a misdemeanor of the third degree. (R.C. §§ 3767.13, 3767.99) ('65 Code, § 74.12) Penalty, see § 130.99

#### § 139.09 INTERFERENCE WITH RIGHT OF PERSON TO ENGAGE IN HOUSING TRANSACTIONS BECAUSE OF RACE, RELIGION, OR THE LIKE.

(A) No person, whether or not acting under color of law, shall by force or threat of force willfully injure, intimidate, or interfere with, or attempt to injure, intimidate, or interfere with any of the following:



Is your RETURN ADDRESS completed on the reverse side?

**SENDER:**

- Complete items 1 and/or 2 for additional services.
- Complete items 3, and 4a & b.
- Print your name and address on the reverse of this form so that we can return this card to you.
- Attach this form to the front of the mailpiece, or on the back if space does not permit.
- Write "Return Receipt Requested" on the mailpiece below the article number.
- The Return Receipt will show to whom the article was delivered and the date delivered.

I also wish to receive the following services (for an extra fee):

- 1.  Addressee's Address
  - 2.  Restricted Delivery
- Consult postmaster for fee.

3. Article Addressed to:

Mr. Robert Beck  
 Beck's Construction  
 11-622 Co. Rd. M  
 Napoleon, Ohio 43545

4a. Article Number

Z 357 332 126

4b. Service Type

- Registered  Insured
- Certified  COD
- Express Mail  Return Receipt for Merchandise

7. Date of Delivery

AUG 30 1995

8. Addressee's Address (Only if requested and fee is paid)

5. Signature (Addressee)

*Robert M. Beck*

6. Signature (Agent)

Thank you for using Return Receipt Service.

PS Form 3811, December 1991

U.S. GPO: 1993-352-714

**DOMESTIC RETURN RECEIPT**

Z 357 332 126

**Return Receipt for Certified Mail**

No Insurance Coverage Provided  
 Do not use for International Mail  
 (See Reverse)



Sent to	Robert Beck
Street and No.	11-622 Co. Rd. M
P.O., State and ZIP Code	Napoleon, OH 43545
Postage	\$ .32
Certified Fee	1.10
Special Delivery Fee	1.35
Restricted Delivery	
Return Receipt to Whom & Delivered	26 1.10
Return Receipt to Whom, Date, and Addressee's Address	
TOTAL Postage & Fees	\$ 2.52
Postmark or Date	(bnd)

CITY OF NAPOLEON  
 P.O. BOX 151  
 NAPOLEON, OHIO 43545

PS Form 3800, March 1993

UNITED STATES POSTAL SERVICE



Official Business

PENALTY FOR PRIVATE  
USE TO AVOID PAYMENT  
OF POSTAGE, \$300



Print your name, address and ZIP Code here

**CITY OF NAPOLEON  
P.O. BOX 151  
NAPOLEON, OHIO 43545**

**STICK POSTAGE STAMPS TO ARTICLE TO COVER FIRST CLASS POSTAGE.  
CERTIFIED MAIL, FEES AND CHARGES FOR ANY SELECTED OPTIONAL SERVICES (see front).**

1. If you want the receipt postmarked, stick the gummed stub to the right of the return address leaving the receipt attached and present the article at a post office service window or hand it to your rural carrier (no extra charge).
2. If you do not want this receipt postmarked, stick the gummed stub to the right of the return address of the article, detach and retain the receipt, and mail the article.
3. If you want a return receipt, write the certified mail number and your name and address on a return receipt card, Form 3811, and attach it to the front of the article by means of the gummed ends if space permits. Otherwise, affix to back of article. Endorse front of article **RETURN RECEIPT REQUESTED** adjacent to the number.
4. If you want delivery restricted to the addressee, or to an authorized agent of the addressee, endorse **RESTRICTED DELIVERY** on the front of the article.
5. Enter fees for the services requested in the appropriate spaces on the front of this receipt. If return receipt is requested, check the applicable blocks in item 1 of Form 3811.
6. Save this receipt and present it if you make inquiry.

105603-93-B-0218

SERVICE CONNECTION INFORMATION

Plan sh. no. 29

St. name Daggett Sta. of wye 3+19

Owner \_\_\_\_\_ Address 701

Person contacted \_\_\_\_\_ Date 11-23-90

Parcel no. \_\_\_\_\_ Lot no. \_\_\_\_\_ Size \_\_\_\_\_

Exit. house X Future house \_\_\_\_\_

Location per owner \_\_\_\_\_

Window sill elev. \_\_\_\_\_

Basement depth \_\_\_\_\_ +sump depth \_\_\_\_\_

Elev. bottom of sump \_\_\_\_\_ = \_\_\_\_\_

Dist. to road R/W \_\_\_\_\_ 1% = \_\_\_\_\_

Needed elev. @ R/W \_\_\_\_\_ = \_\_\_\_\_

Material used \_\_\_\_\_

1 Wye \_\_\_\_\_

2 Bends \_\_\_\_\_

Riser \_\_\_\_\_

Bend \_\_\_\_\_

6" Pipe \_\_\_\_\_

Wye or vee \_\_\_\_\_

6" Pipe \_\_\_\_\_

Plug \_\_\_\_\_

Ground elev. @ R/W 669.49

Inv. 6" S.C. @ R/W 662.64

Inv. 6" S.C. @ main 657.96

(see other side for ref. & notes)

SERVICE CONNECTION INFORMATION

Plan sh. no. 29

St. name DAGGETT Sta. of wye H37+

Owner \_\_\_\_\_ Address 624

Person contacted \_\_\_\_\_ Date 3-13-91

Parcel no. \_\_\_\_\_ Lot no. \_\_\_\_\_ Size \_\_\_\_\_

Exit. house \_\_\_\_\_ Future house \_\_\_\_\_

Location per owner See Record 11-1

Window sill elev. \_\_\_\_\_

Basement depth \_\_\_\_\_ +sump depth \_\_\_\_\_

Elev. bottom of sump \_\_\_\_\_ = \_\_\_\_\_

Dist. to road R/W \_\_\_\_\_ 1% = \_\_\_\_\_

Needed elev. @ R/W \_\_\_\_\_ = \_\_\_\_\_

Material used \_\_\_\_\_

1 Wye \_\_\_\_\_

2 Bends \_\_\_\_\_

Riser \_\_\_\_\_

Bend \_\_\_\_\_

6" Pipe \_\_\_\_\_

Wye or vee \_\_\_\_\_

6" Pipe \_\_\_\_\_

Plug \_\_\_\_\_

Ground elev. @ R/W 669.17

Inv. 6" S.C. @ R/W 661.45

Inv. 6" S.C. @ main 656.70 ± @ 12" MIN. 1

IMV @ wye 19' OUT

\* (see other side for ref. & notes)

11-3-94

582 Becklec

